

Installation instructions for the three in one swing

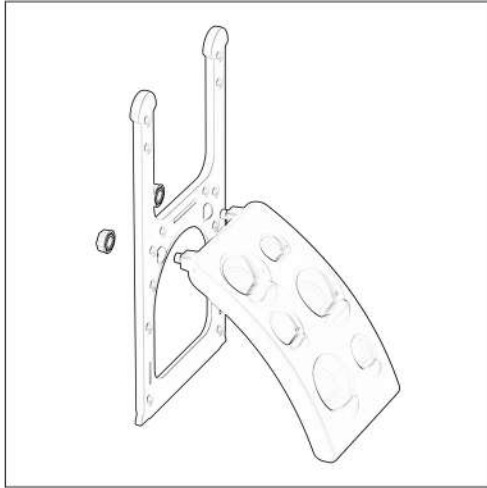

Step 1: Connect the climbing and U-shaped side panels with two hexagonal nuts as shown in the figure

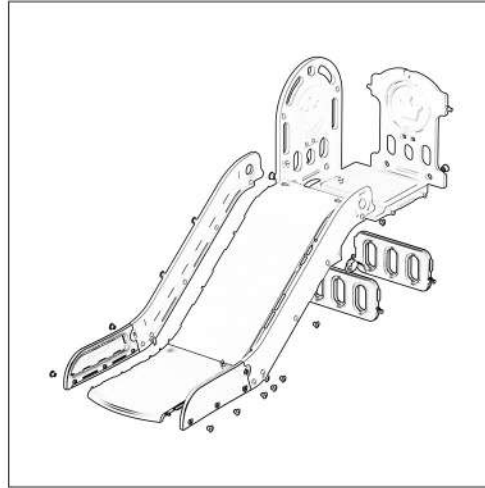

Step 2: Assemble the side plate, upper side plate, lower baffle, and platform with large nuts as shown in the figure. Then, use large nuts to assemble the slide tongue side plate and slide tongue of the slide, and connect the two with large nuts

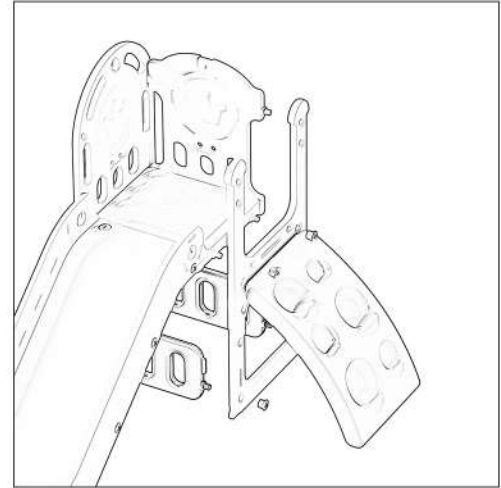

Step 3: Connect the installed climbing device and slide it with a large nut, as shown in the figure

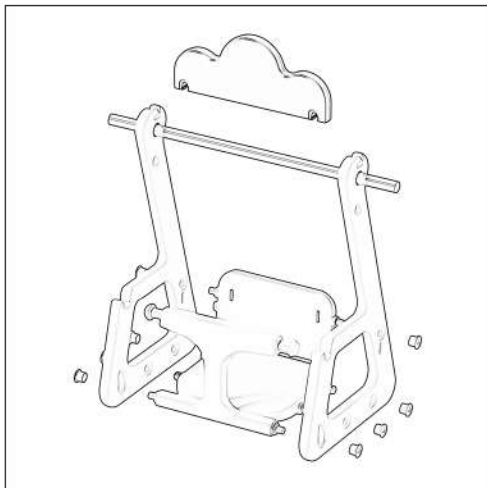

Step 4: Connect the swing side panel, swing front panel, and swing seat backrest with a large nut as shown in the picture

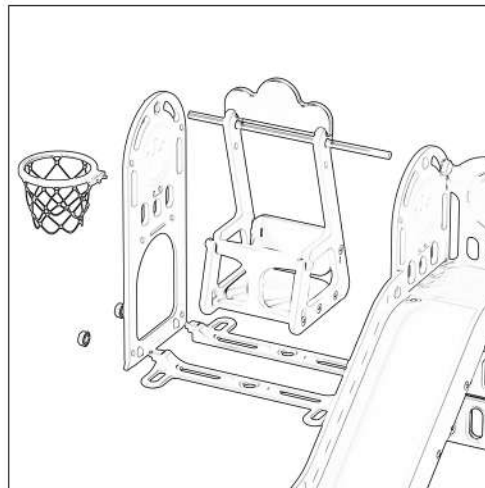

Step 5: Connect the crown side panel swing crossbeam swing base with a five corner nut and a large nut, then hang the swing onto the crossbeam with a rope, and assemble the basketball frame with a small nut

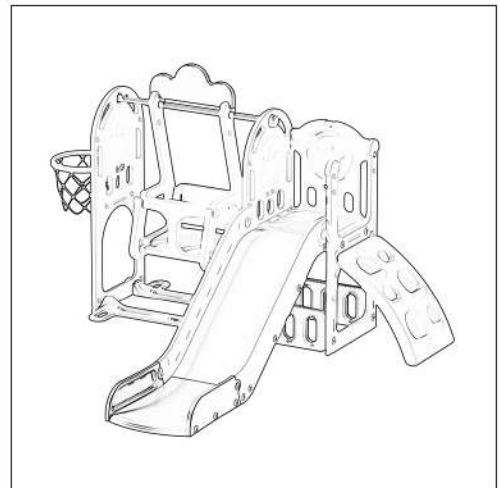

Step 6: Installation completed

Product Parts

